

MURDISHAW LOCAL CENTRE

PUBLIC CONSULTATION

Onward Homes own and manage properties in Murdishaw. Onward is committed to ongoing investment in Murdishaw to regenerate the area and deliver major economic and social benefits to the community.

Onward has been working closely with the Community Design Team, a group of local community residents, to understand their aspirations for the future of Murdishaw. In partnership with the Community Design Team, we have developed plans for a new local centre, which will support a range of activities for local people.

These proposals provide an opportunity to deliver improved public spaces and a new local centre in the heart of your neighbourhood.

Before we progress with the plans, we want to hear from residents. How would you use the local centre? What do you think your area needs? Please turn over to find out more about the proposals and how you can share your feedback through our public consultation.



YOUR COMMUNITY, YOUR WAY.

In partnership with the Community Design Team, Onward has developed a vision for a new local centre. We worked with the Community Design Team, a group of residents from Murdishaw, to share ideas and gather evidence before developing the plans for the local centre.

Working with the Community Design Team and other local representatives, we have focused on designing a space that reflects people's own experiences, knowledge, and aspirations – making sure that local voices are at the heart of this project.

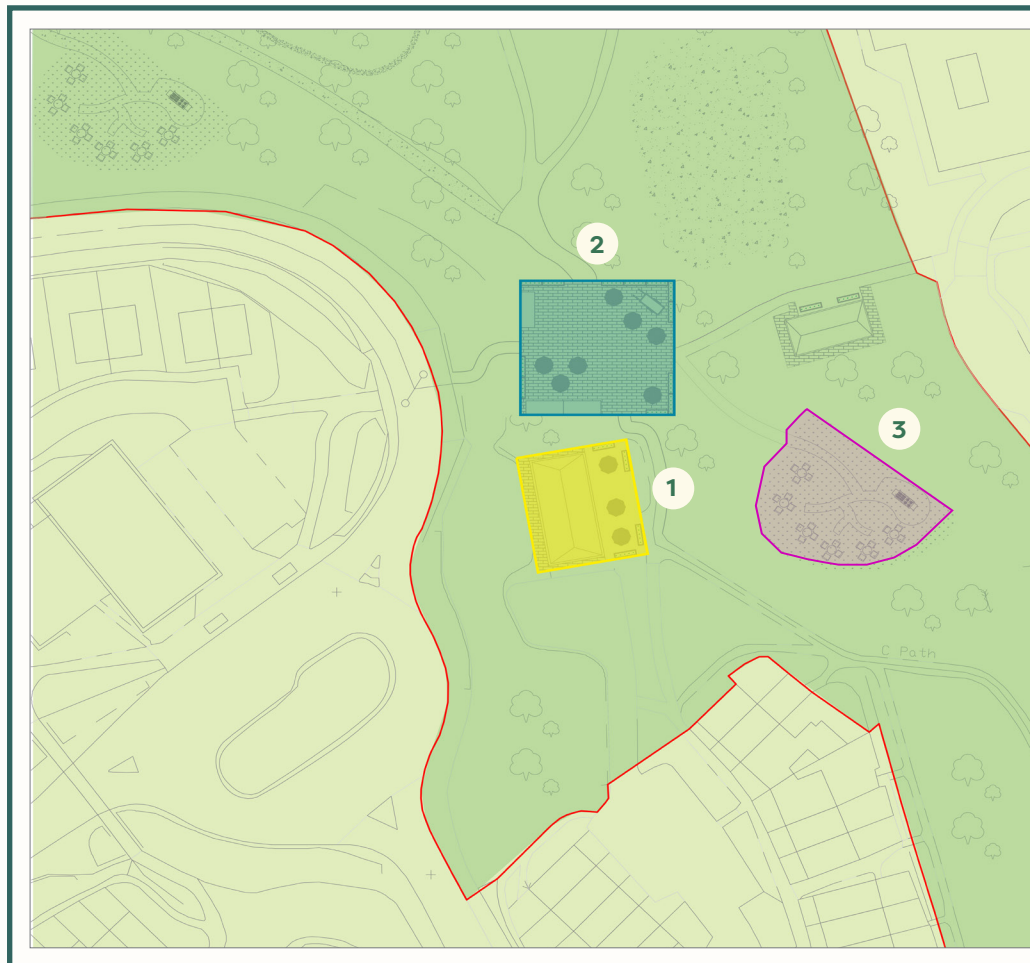

REFLECTING ON LOCAL FEEDBACK.

We sought feedback from the Community Design Team and other local representatives on what they would like to see in the area.

From the feedback received, it was clear that local people wanted somewhere to meet informally as a community, somewhere to learn and share skills and participate in activities at different times of the day. Based on this feedback, we agreed some key principles for the local centre to reflect as many different interests and aspirations as possible.



OUR VISION.

Our ambition is to create a thriving community space where residents can meet and find common things to do together. The local centre will be a vibrant hub in the heart of Murdishaw, providing improvements to green spaces and residents with access to a range of facilities. In summary, the proposals will:

- 1.** Open up the former boxing gym as a café, which will act as the main anchor in the centre of the site
- 2.** Create a new Market Square with hard standing, stalls and shipping containers that could support pop-up shops, makers markets and food events
- 3.** Deliver improvements to the green spaces around the centre, creating new areas for recreational use

The plans present a huge opportunity to create a positive space in the Murdishaw for both existing and future residents. Before we progress with the proposals, we want to hear from local people. Please turn over to find out how you can take part in our consultation.

WHAT HAPPENS NEXT?

Please take this opportunity to let us know what you think about the plans. We are launching a public consultation on **15th December 2021**, which will run until **26th January 2022**.

We will be holding a public exhibition, which will take at Onward's Gorsewood Christmas Market event on **Wednesday 15th December 2021, 1pm – 4pm at Gorsewood Path**.

If you are unable to attend, we will be holding another exhibition event at the Gorsewood Path on **Tuesday 11th January 2022, 2pm – 6pm**.

Members of our project team will be available to discuss the proposals for the new local centre and answer any questions you may have. We will also have feedback forms on hand to capture your thoughts.

If you are unable to make our consultation exhibition, you can review the proposals and download our feedback form by visiting our website at: **www.onward.co.uk/murdishaw-consultation**.

The website will go live on **Wednesday 15th December**.

You can also get in contact by emailing **murdishaw@onward.co.uk**

Alternatively, if you have any difficulties accessing this information, please contact us or call our neighbourhood specialists.

Jane Smith **07881 857 965**

Vickie Hodgson **07733 002 414**

Please provide your feedback no later than Wednesday 26th January 2022.

ABOUT US.

Onward Homes is one of the largest registered providers of social housing in the North West, owning and managing 35,000 properties across the Region. Find out more about Onward at **www.onward.co.uk**